

創伶空間租用詳情 (1 JAN 24 生效)

地址：荔枝角青山道700號時運中心1602室 (港鐵站步行5分鐘到達)

- 歡迎WHATSAPP 95379380 預約參觀/ 查詢及預約場地

辦公時間：星期一至五, 上午9時至下午6時

非辦公時間：星期一至五, 下午6時至10時;

星期六、日及公眾假期, 上午9時至下午10時

- 其他時間另議

- 場地以自助形式使用, 其他詳情請參閱創伶空間守則



- 長者活動、指定機構、長期租用可享低至6折優惠!

- 任何空間連續租用4小時或以上額外9折

*另設場地贊助, 歡迎查詢



主廳

830 ft² | 最多可容納70人

適合舉辦市集、講座及研討會、興趣班、工作坊

包括：8張可疊式枱及70張椅子、
120"高清螢幕、超短距投影機、
HDMI線連Type-C轉插、無線簡報遙控器
音響系統及4枝無線麥克風

辦公時間：每小時HK\$700

非辦公時間：每小時HK\$800

額外租用優惠：

空中庭院 (約2000 ft²)

包括：1張可疊式枱及4張長椅子

HK\$500 (4小時)

HK\$800 (8小時)

★ 租用主廳兩小時或以上, 可免費使用休憩區
連電視作接待處及茶水間 (需預先確認)



多用途室

245 ft² | 最多可容納24人 (講座形式)

或 18人 (連枱工作坊形式)

適合開會、舉辦興趣班及工作坊

包括：5張可疊式枱或一張大枱 (2.74x1.525m)、
26張椅子、螢幕牆、短距投影機、
HDMI線連Type-C轉插

辦公時間：每小時HK\$200

非辦公時間：每小時HK\$230

創伶空間租用詳情 (1 JAN 24 生效)



活動室

145 ft² | 最多可容納12人 (連枱工作坊形式)
適合開會及舉辦小型興趣班

包括: 4張可疊式枱、15張椅子

辦公時間: 每小時HK\$150
非辦公時間: 每小時HK\$180



製作室

175ft² | 最多可容納15人
適合直播、拍攝及攝錄

包括: 4張可疊式枱及15張椅子、
拍攝背景 (綠、白、灰), 天花燈組x2, 上網線
*如需要其他設備可另議

辦公時間: 每小時HK\$200
非辦公時間: 每小時HK\$230



空中庭院

約2000 ft²
適合舉辦戶外活動、運動班及聚會等

包括: 1張可疊式枱、4張長椅子、燈光 (晚間使用)、
洗手盆
*如需要其他設備可另議

辦公時間: 每小時HK\$600
非辦公時間: 每小時HK\$700

其他設施及服務包括:

無線網絡	免費
白板	需預先確認
圓高枱	免費
儲物箱	HK\$150/月 (小) HK\$200/月 (大)
天台儲物空間	HK\$500/月 (一格)
短期展覽商品	另議



免費宣傳!

只要活動適合年長者參與, 經雙方同意後,
免費於合作機構-尊賢會社交平台及「快樂之友」
手機應用程式「最新消息」宣傳

宣傳及招募服務 (優惠限於創伶空間舉辦的活動)
包括範本海報、宣傳文字、招募及行政工作
HK\$500/30人或以下單次性活動
HK\$800/30-70人單次性活動

場地圖

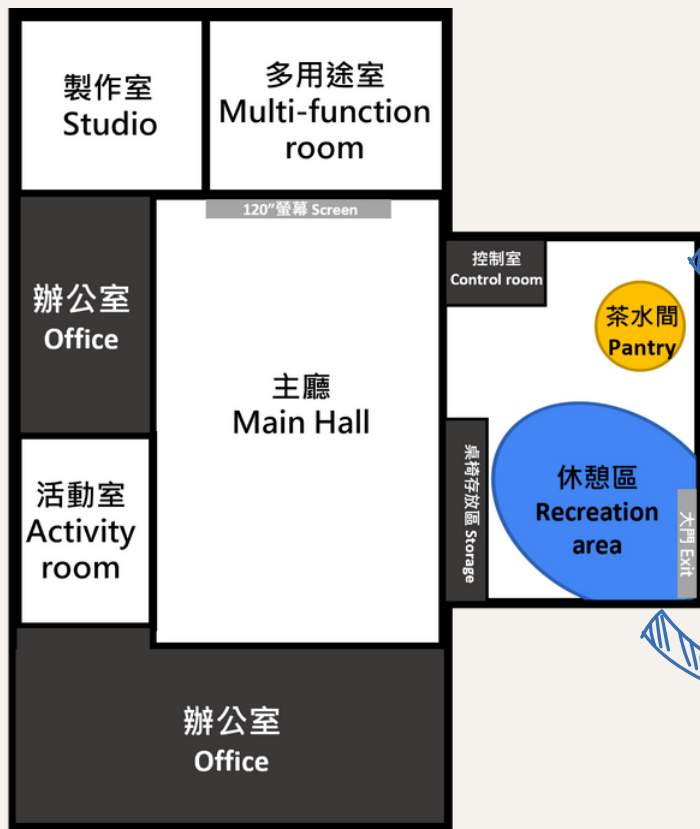

設施



可疊式枱
180x 74cm



儲物箱
小: 53x 36x 31 (H)cm
大: 64x 43x 35(H)cm



圓高枱
60x 60cm
60-90(H)cm 可調教

Innoage Space Rental Package

(Effective date: 1 Jan 2024)

Address: Room 1602, Charm Centre, 700 Castle Peak Road, Lai Chi Kok
(5 mins walk from Lai Chi Kok MTR Station)

Appointments or inquire about visiting: WhatsApp at 95379380

Office hours: Monday to Friday, 9:00 AM to 6:00 PM

Non-office hours: Monday to Friday, 6:00 PM to 10:00 PM;

Saturday, Sunday, and public holidays, 9:00 AM to 10:00 PM

- Other times can be discussed
- Self-serve. For more details, please refer to the rules and regulations



- Up to 40% off for senior activities, designated organizations, and long-term rentals!
 - Additional 10% off for continuous rentals of 4 hours or more.
- *Sponsorship is also available.
Feel free to inquire.



MAIN HALL

830 ft² | Maximum capacity of 70 people
Suitable for hosting markets, lectures and seminars, interest classes, workshops

Includes: 8 stackable tables and 70 chairs, 120" HD screen, ultra-short throw projector, HDMI cable with Type-C adapter, wireless presentation remote, sound system, and 4 wireless microphones

Office hours: HK\$700/hr

Non-office hours: HK\$800/hr

Additional rental offer:

Rooftop (approximately 2000 ft²)

Includes: 1 stackable table and 4 long benches

HK\$500 (4 hours)

HK\$800 (8 hours)

Rent for more than 2 hours, free lounge area with a TV and the pantry (on request)



MULTI FUNCTION ROOM

245 ft² | Maximum capacity of 24 people (lecture format) or 18 people (workshop format with tables)

Suitable for meetings, hosting interest classes, and workshops

Includes: 5 stackable tables or 1 large table (2.74x1.525m), 26 chairs, screen wall, short throw projector, HDMI cable with Type-C adapter

Office hours: HK\$200/hr

Non-office hours: HK\$230/hr

For inquiries and reservations: 21997576/ WhatsApp 95379380/ contact@innoagehub.com



ACTIVITY ROOM

145 ft² | Maximum capacity of 12 people (workshop format with tables)

Suitable for meetings and hosting small interest classes

Includes: 4 stackable tables, 15 chairs

Office hours: HK\$150/hr
Non-office hours: HK\$180/hr



STUDIO

175 ft² | Maximum capacity of 15 people

Suitable for live streaming, photography, and recording

Includes: 4 stackable tables and 15 chairs, shooting backgrounds (green, white, gray), 2 ceiling light sets, internet connection

*For additional equipment requirements, please discuss separately

Office hours: HK\$200/hr
Non-office hours: HK\$230/hr



ROOFTOP

Approximately 2000 ft².

Suitable for outdoor activities, sports classes, gatherings, and more.

Includes: 1 stackable table, 4 long benches, lighting (for evening use), washbasin

*For additional equipment requirements, please discuss separately

Office hours: HK\$600/hr
Non-office hours: HK\$700/hr

Other facilities and services:

Wireless Internet	Free
Whiteboard	On request
Round high table	Free
Storage lockers	HK\$150/month (small) HK\$200/month (large)
Rooftop storage space	HK\$500/month (one compartment)
Rental for short-term exhibition	To be discussed

For inquiries and reservations: 21997576/ WhatsApp 95379380/ contact@innoagehub.com

Website: innoagehub.com

Facebook: Innoage Hub 創伶滙



Free Promotion!

On The Jade Club Facebook/ News on 'Happy Friends Mobile app' upon mutual agreement and events related to elderly

Promotion and Recruitment Services (discounts limited to events held at Innoage Space)

Including template posters, write-up, recruitment, and administration

HK\$500 per event with 30 people or less

HK\$800 per event with 30-70 people

Appendix: Floor plan and dimension of facilities

Floor Plan



Facilities



Stackable table
180x 74cm



Storage
Small: 53x 36x 31 (H)cm
Large: 64x 43x 35(H)cm



Round bar table
60x 60cm
60-90(H)cm (Adjustable)

For inquiries and reservations: 21997576/ WhatsApp 95379380/ contact@innoagehub.com

Website: innoagehub.com

Facebook: Innoage Hub 創伶滙